



ANN STREET, ISLINGTON, N1

1 BED APARTMENT

£2,800 PCM

A beautifully presented one bedroom 6th floor apartment in the popular Packington Square development, situated in the heart of Angel, Islington. This one bedroom apartment boasts approximately 550 Sq ft of living space. The property comprises of an open plan kitchen living area, private balcony with views over the City, double bedroom with fitted wardrobes and a contemporary bathroom suite.

Packington Square is located in the ever popular Angel, Islington. The Regents Canal is moments away and Upper Street is just 0.3 miles from the development. Angel station, Zone 1 is 0.7 miles away.

Available 30th June 2025 on a furnished basis.

Hemmingfords

Ann Street, N1
 Approximate Gross Internal Area
 544 sq ft / 50.58 sq m

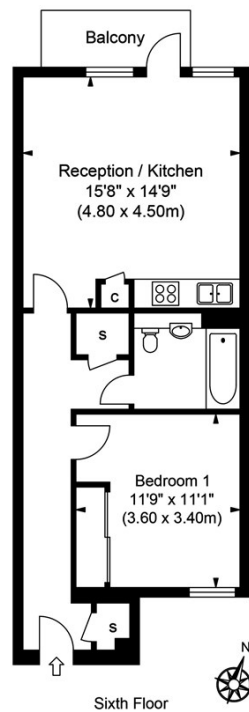

ILLUSTRATION FOR IDENTIFICATION PURPOSES ONLY
 ALL MEASUREMENTS ARE APPROXIMATE AND INCLUDE WINDOW SITES AND FINISHES WHERE APPLICABLE
 THIS PLAN MUST NOT BE REPRODUCED BY ANY OTHER PERSON WITHOUT PERMISSION



Energy Efficiency Rating		
	Current	Potential
Very energy efficient - lower running costs		
(92 plus) A		
(81-91) B		
(69-80) C		
(55-68) D		
(39-54) E		
(21-38) F		
(1-20) G		
Not energy efficient - higher running costs		
England & Wales	82	82
	EU Directive 2002/91/EC	

Agents Note: Whilst every care has been taken to prepare these particulars, they are for guidance purposes only. All measurements are approximate and are for general guidance purposes only and whilst every care has been taken to ensure their accuracy, they should not be relied upon and potential buyers/tenants are advised to recheck the measurements

Hemmingfords Lettings
 34 Upper Street
 London
 N1 0PN

020 3890 7470
 info@hemmingfords.co.uk
 www.hemmingfords.co.uk

Hemmingfords